

**△ LOT GRADING**

1. BUILDING PAD ELEVATION TO BE DETERMINED BY LOT DRAINAGE CRITERIA AS SHOWN ABOVE FOR R-1 ZONING ONLY

**SECTION A-A**

2. GRADE TOWARD STREET AWAY FROM HOUSE

NO.	REVISED	BY	<b>Typical Interior Lot Grading Detail</b>	APPROVED
△	1-2003	MJM		<i>David B...</i>
				CITY ENGINEER RCE-28191
DRAWN BY: M.C.P				DATE: 2-2-99
CHECKED BY: DJR			<b>CITY OF RIPON</b>	STANDARD NO. <b>M-4</b>
SCALE: NONE				

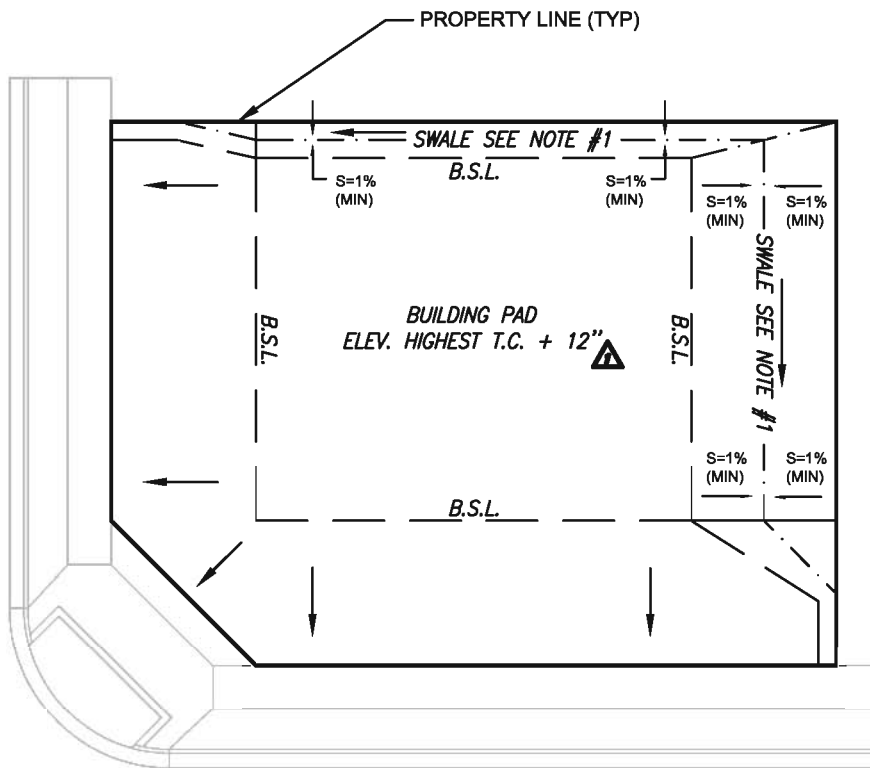

1. AT FINAL INSPECTION FOR A HOUSE, A DRAINAGE SWAIL WITH 1'-0" OR 1% MINIMUM FALL FROM BACK OF LOT TO FRONT OF LOT, WHICHEVER IS LESS, SHALL BE CONSTRUCTED AROUND THE HOUSE TO THE BACK OF LOT, FOR R-1 ZONING ONLY.

$\triangle = \triangle 1-10-03$

NO.	REVISED	BY	<b>Typical Corner Lot Grading Detail</b>	APPROVED
$\triangle$	1-2003	MJM		 CITY ENGINEER RCE-28191
DRAWN BY: MCP				DATE: 2-2-99
CHECKED BY: DJR			<b>CITY OF RIPON</b>	STANDARD NO. <b>M-4a</b>
SCALE: NONE				